

1 PIPING PLAN
A-PL-4 1/8" = 1'-0"

NOTE	FIELD SYMBOL	ACTUAL LOCATION OF DRAIN
WALL-TOP DRAIN (IN FLOOR)	—	—
HYDROSTATIC VALVE	—	—
AUTO FILL	—	—
RETURN INLET (ADJUSTABLE)	—	—
SKIFFER	—	—
800W LIGHT	—	—
H-LITE	—	—
JUNCTION BOX FOR LIGHTS	—	—
FLOOR RETURN	—	—
LAY RIVER	—	—
PIPE	—	—

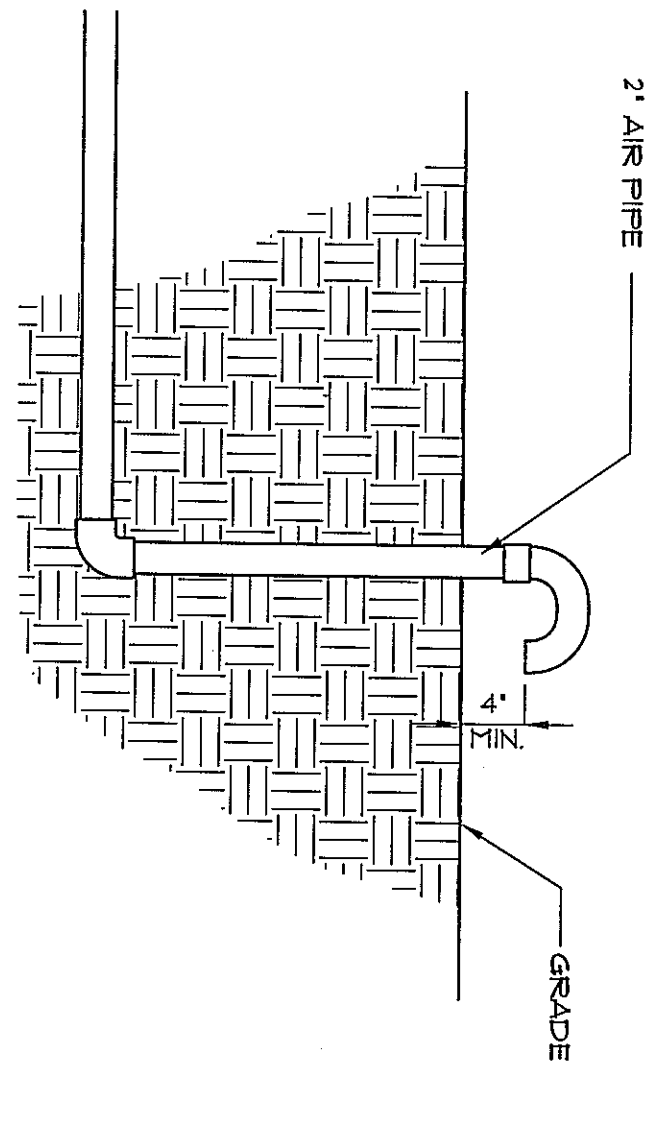

3 RELIEF VENT DETAIL
A-PL-4 NOT TO SCALE

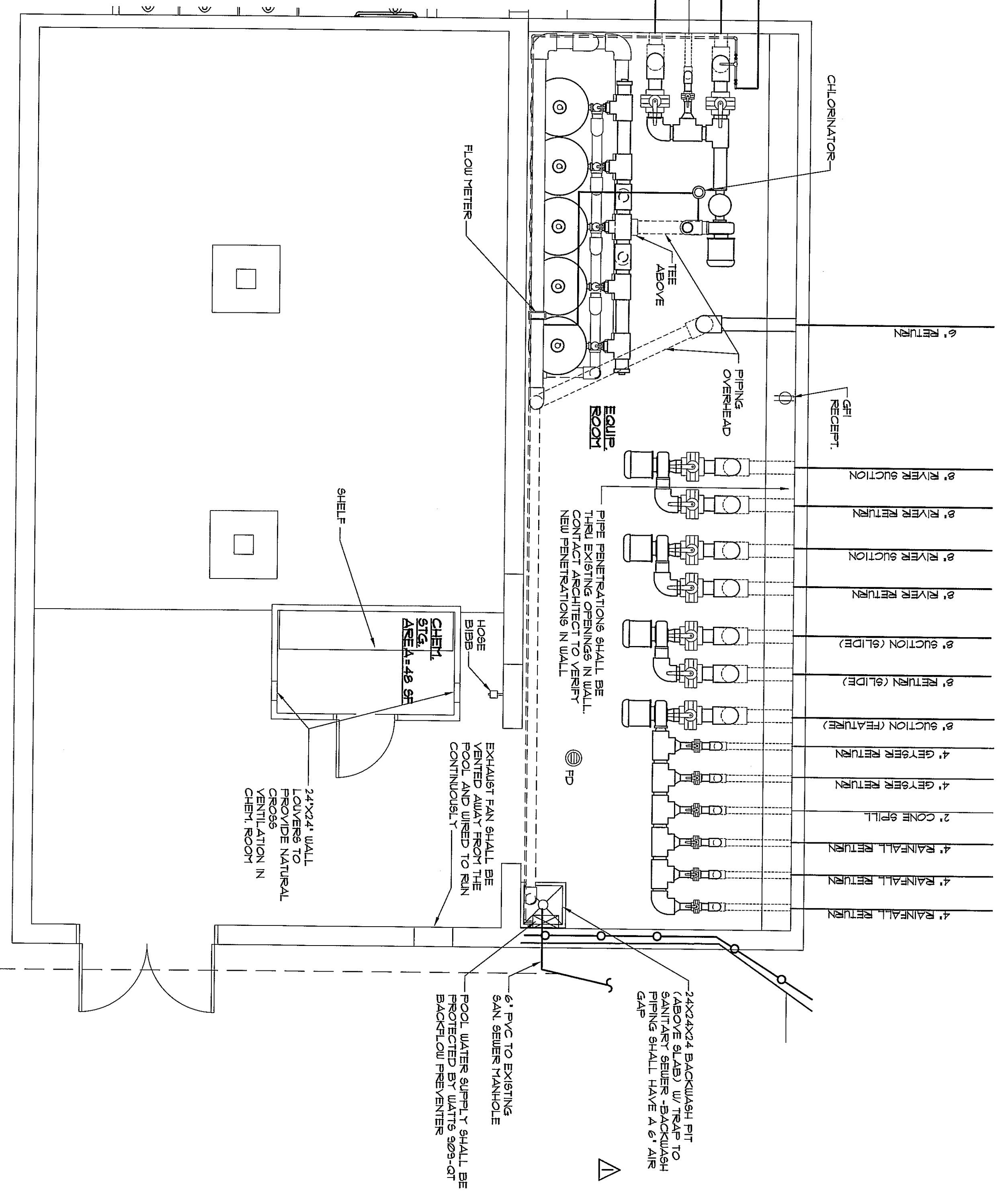

2 EQUIPMENT ROOM PLAN
A-PL-4 1/4" = 1'-0"

- NOTE:
1. FLOW METERS SHALL BE CAPABLE OF MEASURING FLOWS IN BOTH DIRECTIONS.
 2. ALL REQUIRED SIGNALS FOR EQUIPMENT AND CHEMICAL ROOMS SHALL BE PROVIDED BY OTHERS. HOSE BIBBS BY OTHERS, SEE PLUMBING DRAWING FOR DETAILS.
 3. EXHAUST FANS BY OTHERS, SEE ELECTRICAL DUGS, FOR DETAILS.
 4. 8\"/>

SOME ITEMS SHOWN IN THIS DRAWING ARE FOR PERMITTING PURPOSES ONLY. REFER TO THE FOOTING OF WORK FOR SECTION 01 50 FOR SCOPE.

<p>SOUTHERN POOLS</p> <p>4900 SIRUS LANE CHARLOTTE, NC 28208 PHONE: 704-875-9184 FAX: 704-875-8023</p> <p>This drawing and the design shown are the property of Southern Pools. The design of this drawing shall remain the property of Southern Pools. All rights reserved.</p> <p>© 2001 SOUTHERN POOLS</p>	<p>ARCHITECT SEAL</p> <p>WILLIAM H. DAVIS REGISTERED ARCHITECT STATE OF NORTH CAROLINA 11-27-77</p>	<p>1534 E. Worthington Ave. Charlotte, NC 28203 PH: 704-309-9903 FAX: 704-875-8023</p>	<p>South End Architecture PLLC</p>

